

Malini

PLAN SHOWING THE PLOT HAVING AREA 646.717 SQM OR 9.66 KATHA MORE OR LESS INSIDE RS PART PLOT NO- 46 (PART), LR PLOT NO- 158, 159, LR KHATIAN NO- 2615 & 2646 OF MOUZA SANKARPUR, JL NO- 109, PS- NEW TOWNSHIP, DIST- PASCHIM BURDWAN, PIN- 713212 W.B. SHOWN WITH RED BORDER AS-

NAME OF PROJECT- MALINI APARTMENT

NAME OF OWNER- 1. BUDDHADEV DEY, S/O DAKSHINAPADA DEY
2. GOUTAM PAL, S/O BHIBHUTI BHUSHAN PAL
SANKARPUR, JEMUA GRAM PANCHAYET,
PS- N. T. S, DIST- PASCHIM BURDWAN, W.B.

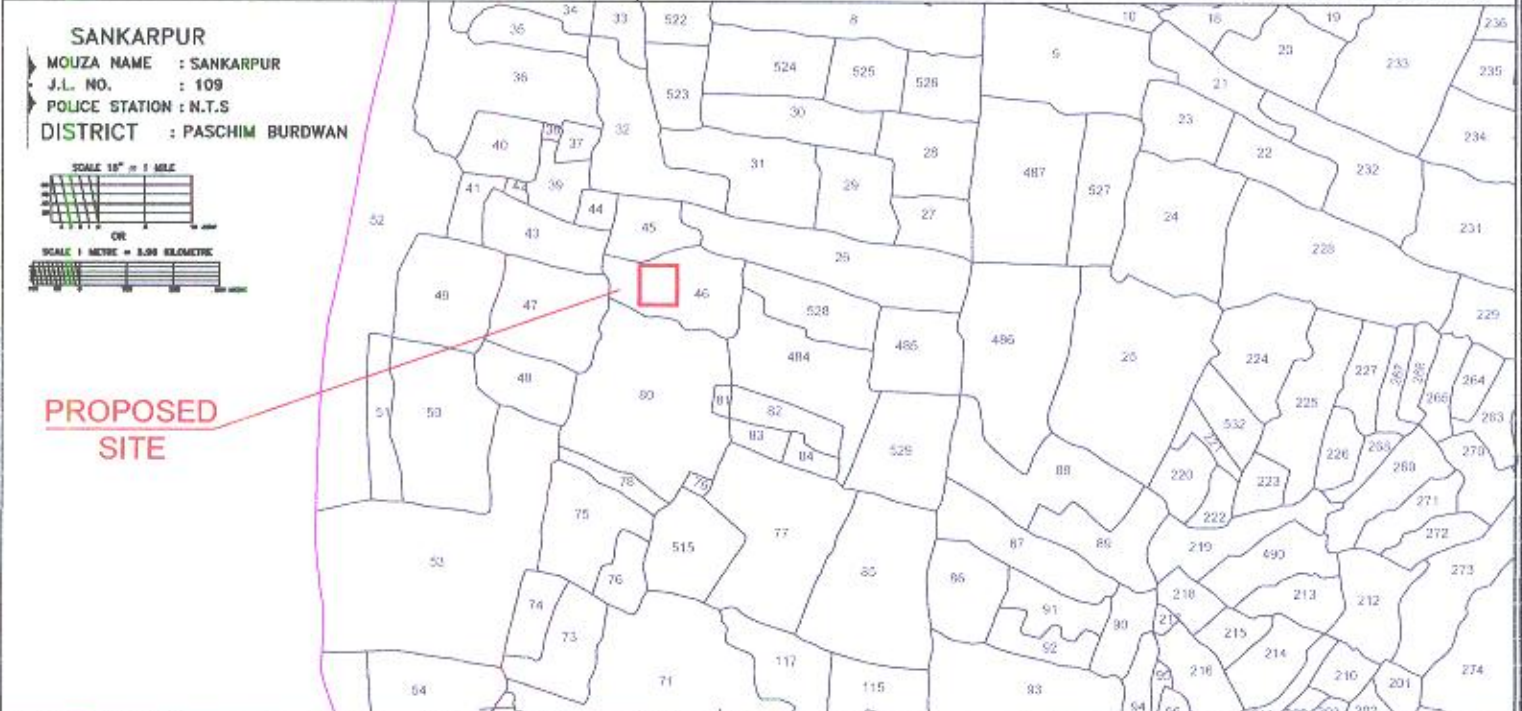
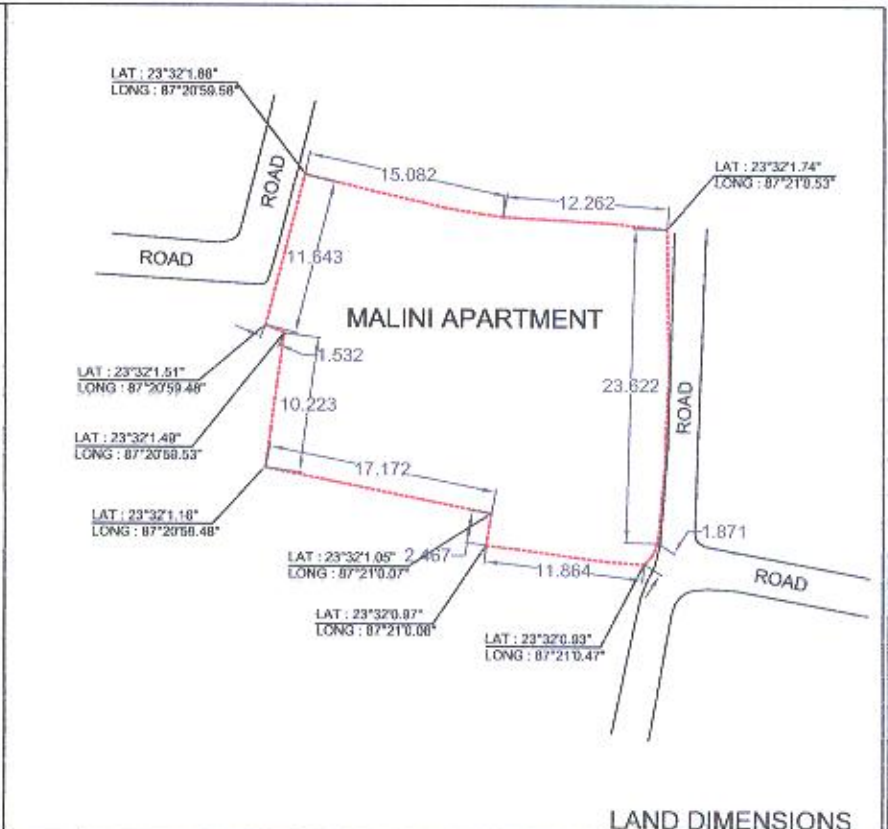

PREPARED BY- GLOBAL SURVEYORS
R/O OFFICE - SEARSOLE BABUPARA
P.O. - SEARSOLE RAJBARI,
DIST - PASCHIM BURDWAN (W.B)
PH: 94342 37231, 9833738281
EMAIL - info@globalsurveyors.org
globalsurveyors2001@yahoo.co.in
WEBSITE - www.globalsurveyors.org
(AN ISO 9001:2015 CERTIFIED FIRM)

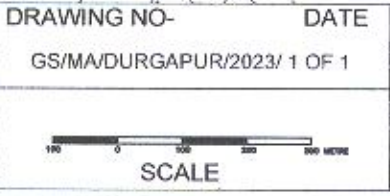
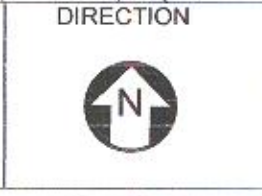

SIGNED & VERIFIED BY- *Banerjee*
GLOBAL SURVEYORS
"PUSPANJALI" SEARSOLE BABU PARA
P.O.-SEARSOLE,RAJ/BARI,P.S.-RANGANJ,PIN-713358
DIST.-PASCHIM BARDHAMAN (W.B)